

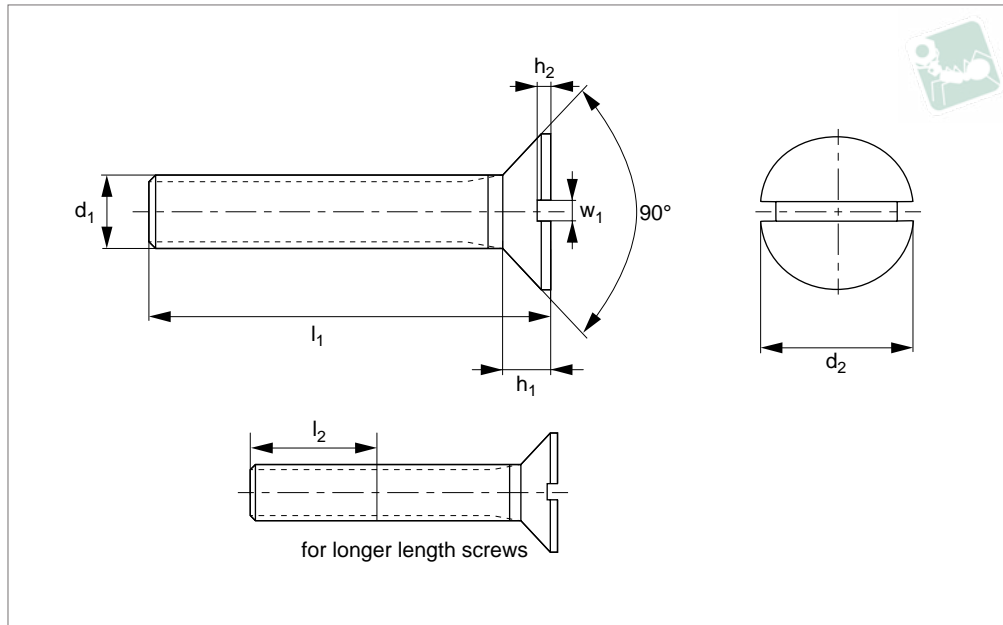

Slotted Csk Head Screws

Slotted csk, DIN 963

Polypropylene



P0013.N2

POLYPROPYLENE

Material
Polypropylene.

Technical Notes

To DIN 963, ISO 2009. For the majority of

screw lengths, the thread goes all the way to the head of the screw (i.e. $l_1 = l_2$) less 2.5 thread pitches. For longer length screws, the threaded portion $l_1 > l_2$.

See technical page for tightening torques.

Order No.	d_1	l_1	d_2	l_2	h_1	w_1	Material	Finish
P0013.060-010	M 6	10	11.0	1.2	3	1.6	Polypropylene	unfinished
P0013.060-015	M 6	15	11.0	1.2	3	1.6	Polypropylene	unfinished
P0013.060-020	M 6	20	11.0	1.2	3	1.6	Polypropylene	unfinished
P0013.080-010	M 8	10	14.5	1.6	4	2.0	Polypropylene	unfinished
P0013.080-015	M 8	15	14.5	1.6	4	2.0	Polypropylene	unfinished
P0013.080-020	M 8	20	14.5	1.6	4	2.0	Polypropylene	unfinished
P0013.080-025	M 8	25	14.5	1.6	4	2.0	Polypropylene	unfinished
P0013.100-015	M 10	15	18.0	2.0	5	2.5	Polypropylene	unfinished
P0013.100-020	M 10	20	18.0	2.0	5	2.5	Polypropylene	unfinished
P0013.100-025	M 10	25	18.0	2.0	5	2.5	Polypropylene	unfinished
P0013.100-030	M 10	30	18.0	2.0	5	2.5	Polypropylene	unfinished